

PT Patroller User Instructions

Instructions Patroller PT • Istruzioni Patroller PT •
Patroller PT Anleitung • Instrucciones Patroller PT •
Patroller PT 手順 • Patroller PT 说明

SEGWAY

Table of Contents

Table des matières • Sommario • Inhaltsverzeichnis •
Contenidos • 目次 • 目录

| | |
|---------------|----|
| English..... | 3 |
| Français..... | 10 |
| Italiano..... | 16 |
| Deutsch..... | 22 |
| Español..... | 28 |
| 日本語..... | 34 |
| 中文..... | 40 |

Safety

WARNING

- Read all instructions in these user materials. Failure to adhere to these warnings could lead to serious injury or death or damage to property.
- Always shut down your Segway PT and unplug the AC Power Cord before performing any maintenance or installing any part or accessory.
- Use only Segway-approved parts, fasteners, and accessories.
- Do not attempt to repair any stripped or damaged screw hole. Instead, replace the part. If replacement part is not available, do not reassemble.
- Insert fasteners slowly and carefully. Do not cross-thread or over-tighten fasteners. Tighten only to the prescribed torque.
- Failure to adhere to these warnings could lead to serious injury or death or damage to property.

QUESTIONS?

If you are missing a part, or if you need to return the product, please contact Segway Customer Operations at 1.866.4SEGWAY (1.866.473.4929) or on our website at www.segway.com/support/contact_us.html. Check www.segway.com for updates to this document. Thank you.

LIMITED WARRANTY

The Segway PT i2 and x2 Patroller models are covered by the Segway® Personal Transporter Limited Warranty (copy delivered with the kit.)

REQUIRED TOOLS:

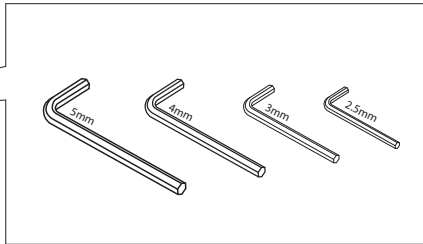
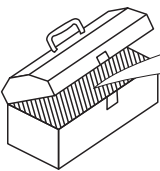

LIGHT

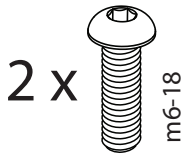

LOWER SHIELD

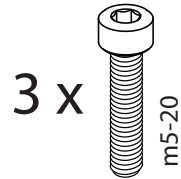

HANDLEBAR BUMPER CLAMP

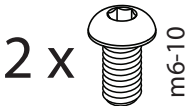

BUMPER

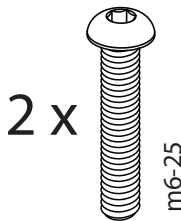

LIGHT BRACKET

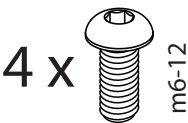

UPPER SHIELD

1-1

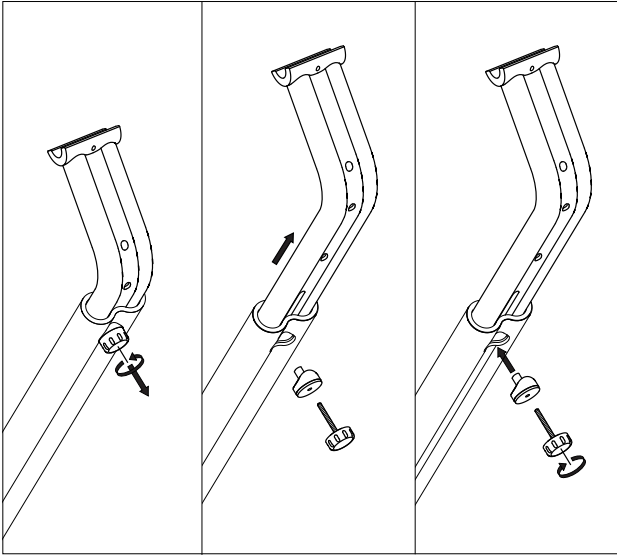

2-1

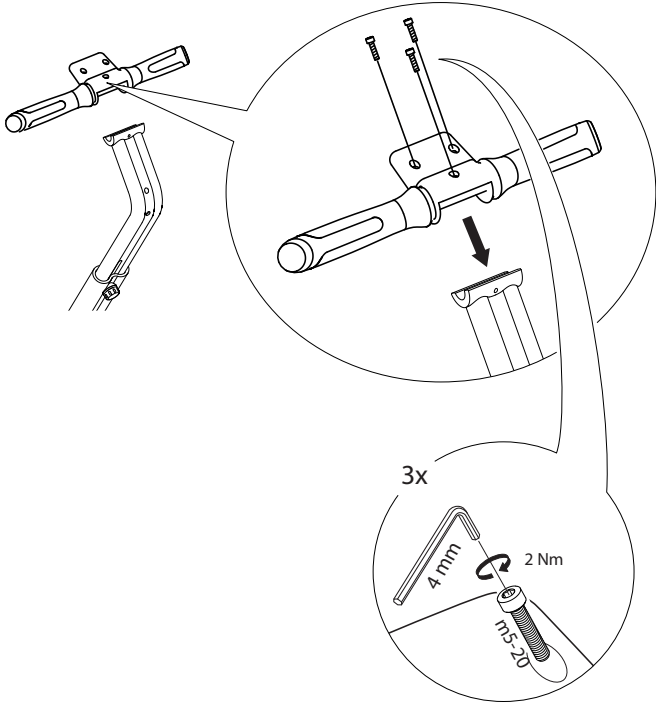

3-1

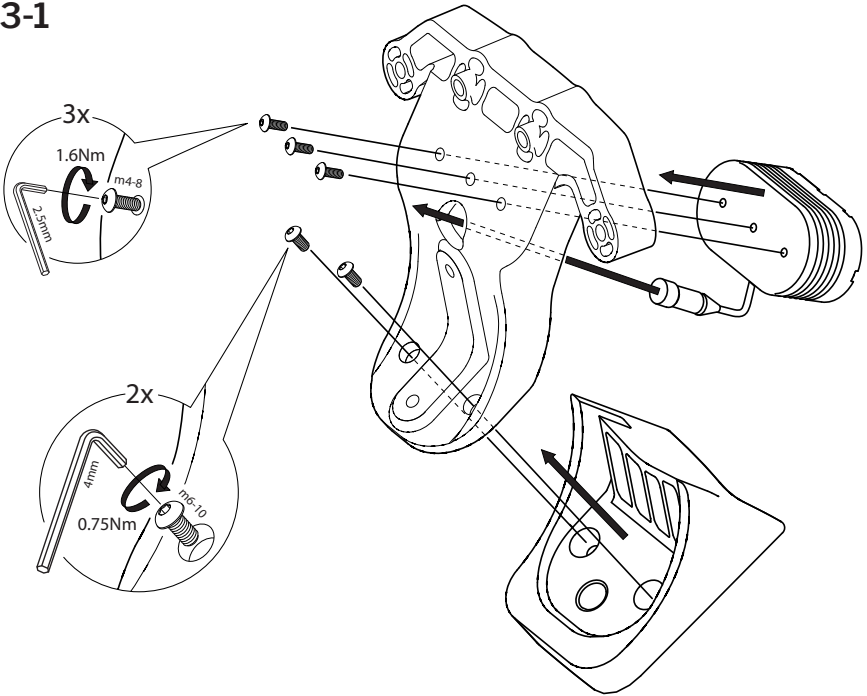

4-1

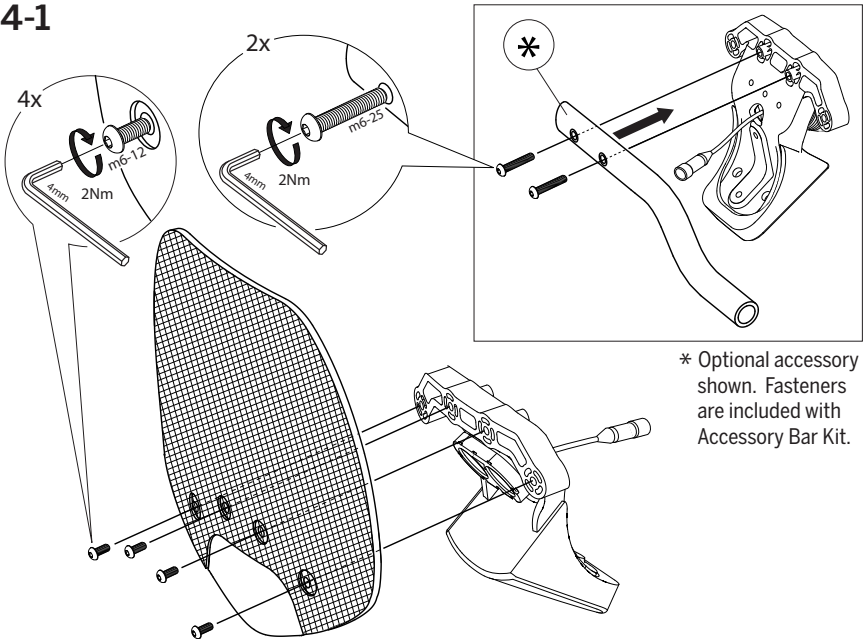

5-1

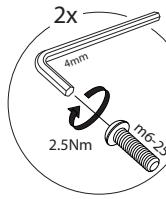
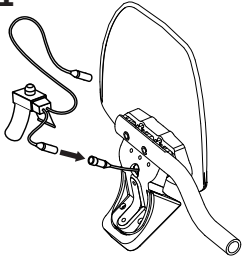

5-2

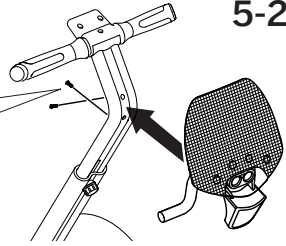

5-3

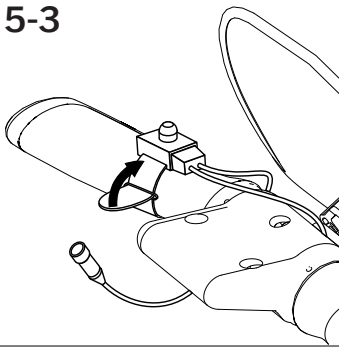

6-1

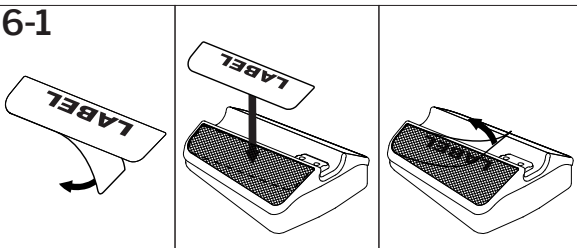

Align corner of label as shown on label application instruction sheet

6-2

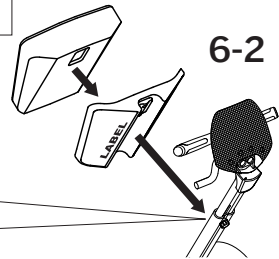

6-3

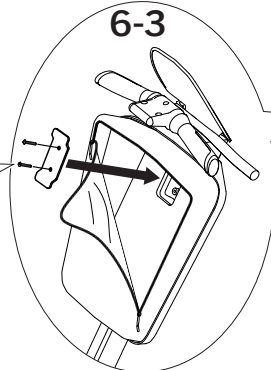
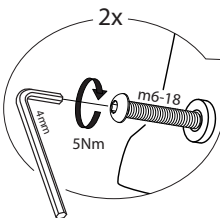

7-1

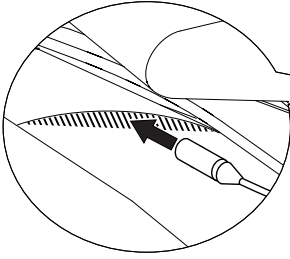

7-2

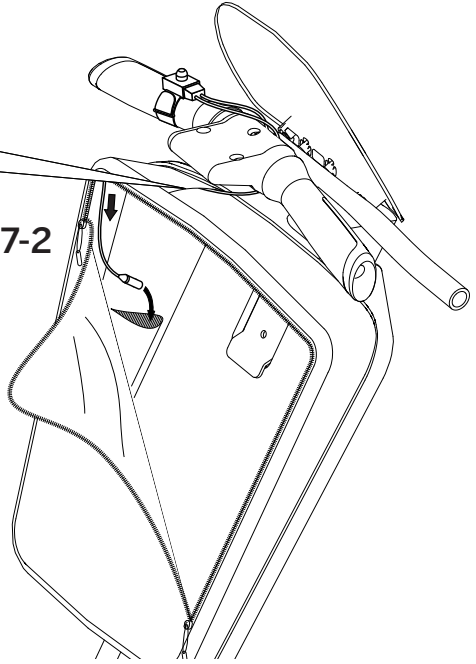

7-3

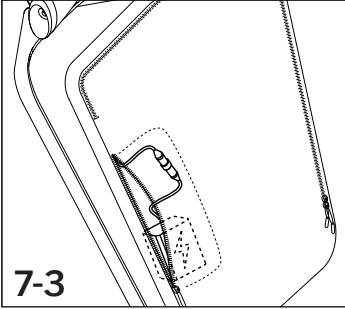

NOTES

Sécurité

AVERTISSEMENT

- Lisez toutes les instructions fournies dans ces manuels d'utilisation. Le manquement à ces avertissements peut entraîner des blessures graves ou endommager l'équipement.
- Arrêtez toujours votre TP Segway et débranchez le cordon d'alimentation CA avant d'effectuer tout entretien ou d'installer une pièce ou un accessoire.
- Utilisez uniquement des pièces, fixations et accessoires approuvés par Segway.
- Ne tentez pas de réparer un trou de vis foiré ou endommagé. Remplacez plutôt la pièce. Si aucune pièce de rechange n'est disponible, ne rassemblez pas.
- Insérez les dispositifs de fixation lentement et avec précaution. Ne serrez pas trop et ne faussez pas le filetage des dispositifs de fixation. Serrez uniquement au couple recommandé.
- Le fait de ne pas respecter ces avertissements peut soumettre l'utilisateur à des risques de blessures graves, voire fatales ou à des dommages matériels.

DES QUESTIONS ?

Si une pièce manque ou si vous devez retourner le produit, veuillez contacter le centre de service à la clientèle de Segway au numéro 1.866.4SEGWAY (1.866.473.4929) ou visitez notre site Internet à l'adresse www.segway.com/support/contact_us.html.

Consultez le site www.segway.com pour connaître les mises à jour apportées à ce document. Merci.

GARANTIE LIMITÉE

Les modèles de Patroller Segway TP i2 et x2 sont couverts par la garantie limitée sur les transporteurs personnels de Segway® (un exemplaire accompagne le kit).

OUTILS NÉCESSAIRES :

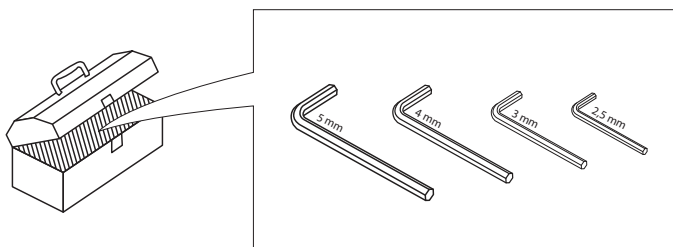

PHARE

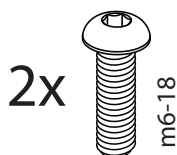

PARE-BRISE
INFÉRIEUR

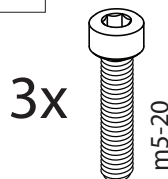

ATTACHE DU
PARE-CHOCS
DU GUIDON

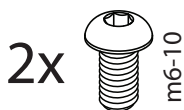

PARE-CHOCS

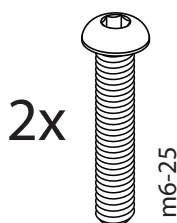

SUPPORT DU PHARE

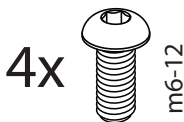

PARE-BRISE
SUPÉRIEUR

1-1

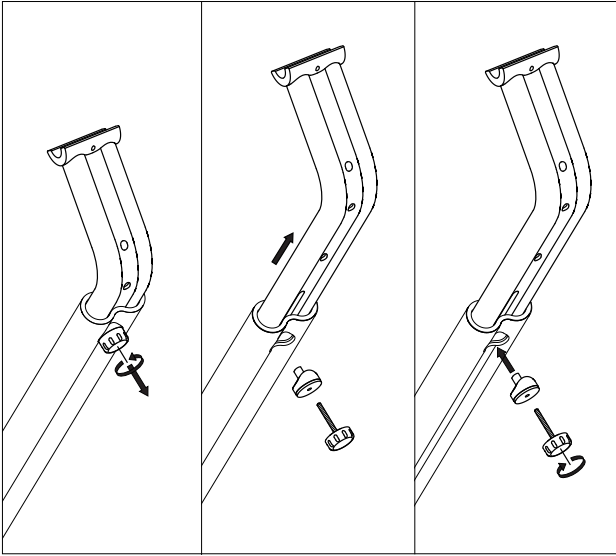

2-1

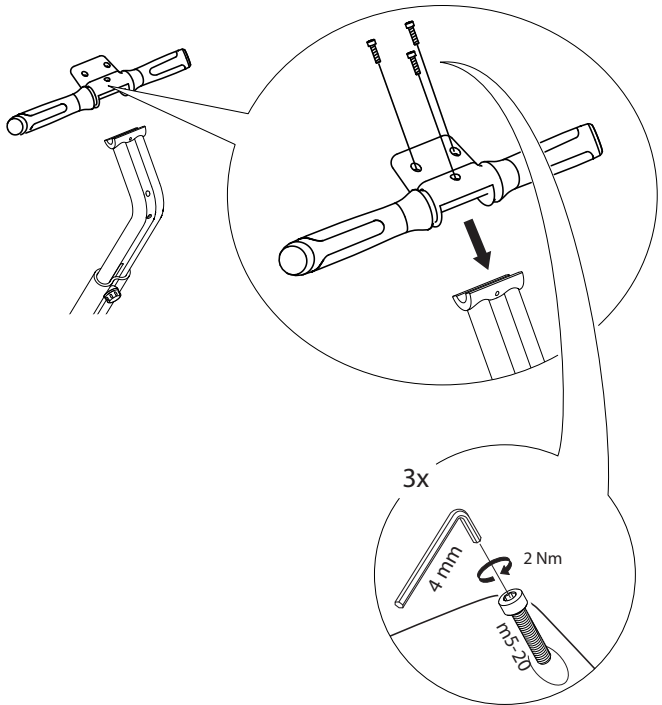

3-1

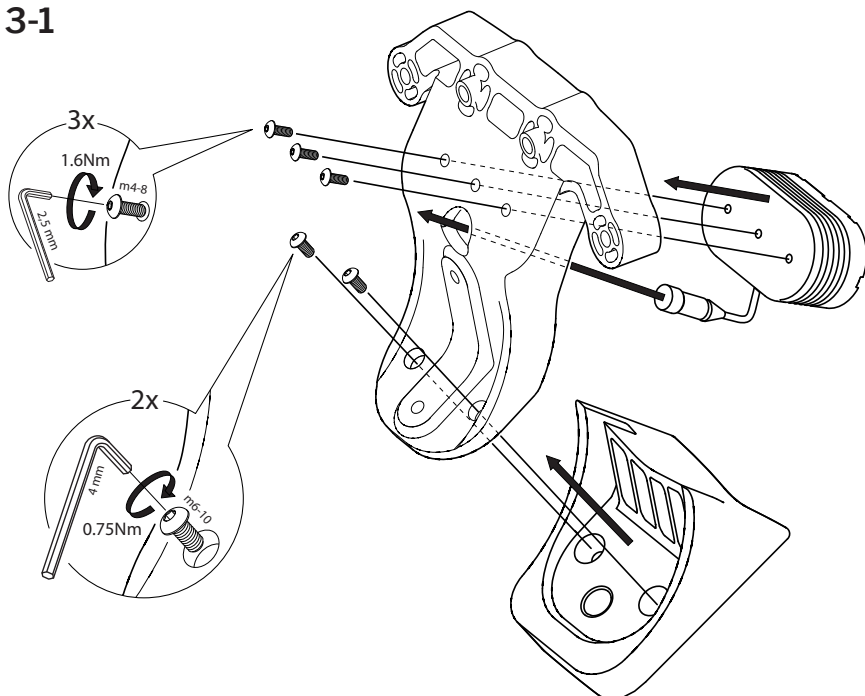

4-1

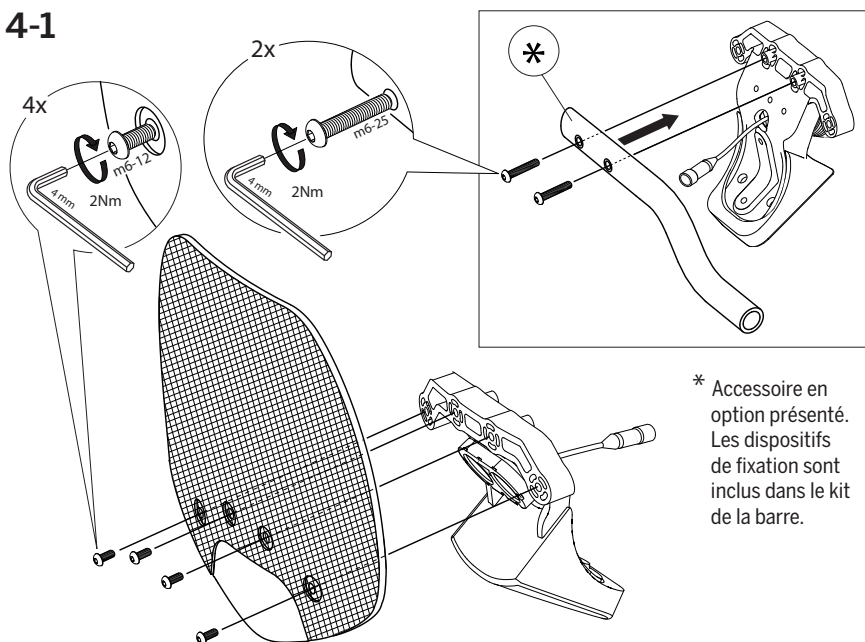

* Accessoire en option présenté. Les dispositifs de fixation sont inclus dans le kit de la barre.

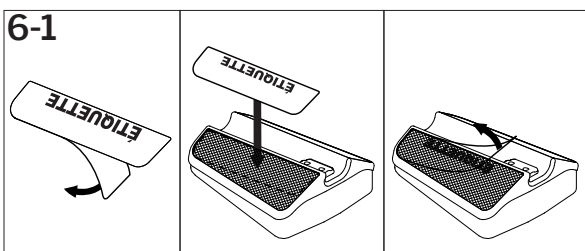
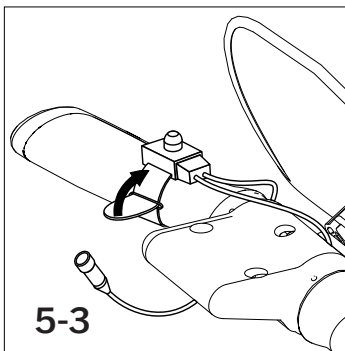
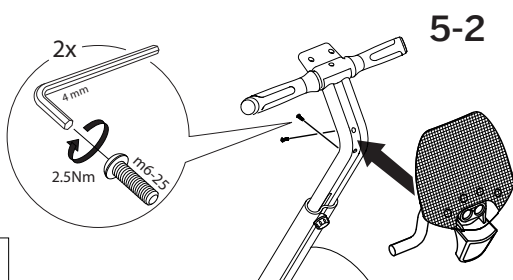
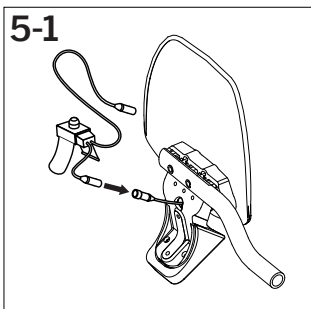

Alignez le coin de l'étiquette en suivant les instructions figurant sur la feuille d'instruction relative à l'application de l'étiquette.

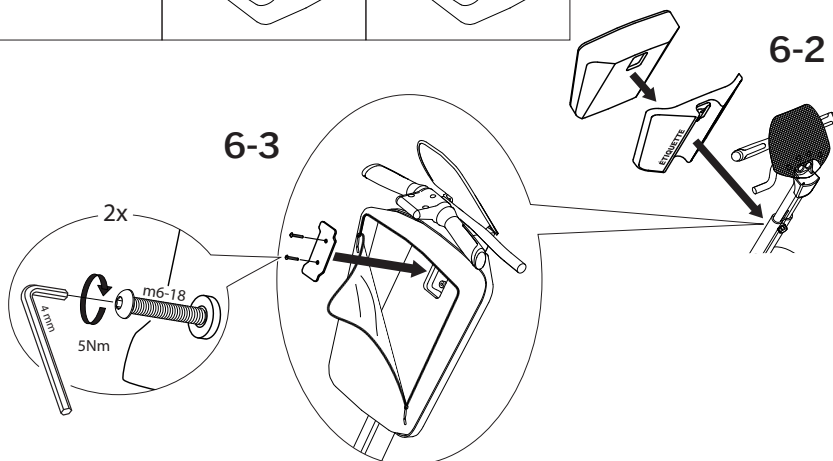

7-1

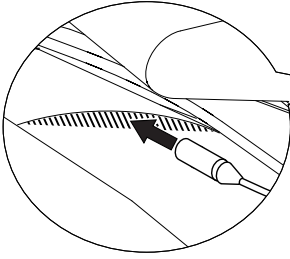

7-2

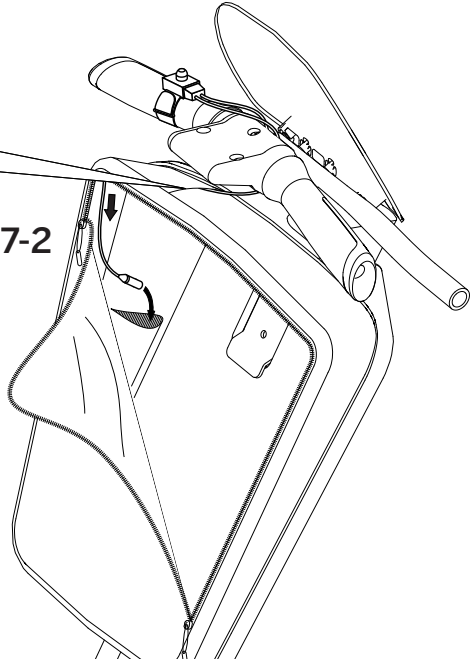

7-3

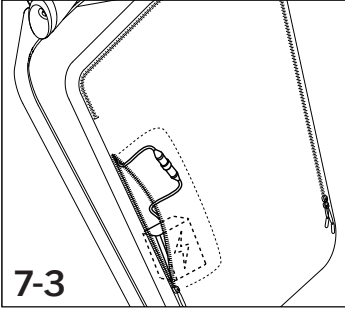

Sicurezza

AVVERTENZA

- Leggere tutte le istruzioni allegate ai componenti. Il mancato rispetto di queste avvertenze potrebbe causare gravi ferite, la morte o danni materiali.
- Spegnerne sempre il Segway PT e scollegare il cavo di alimentazione CA prima di eseguire qualsiasi intervento di manutenzione o l'installazione di qualsiasi parte o accessorio.
- Utilizzare solo ricambi, viti di fissaggio e accessori approvati Segway.
- Non tentate di riparare una vite danneggiata o la cui filettatura abbia ceduto. In questo caso, sostituire invece il componente e qualora il ricambio non fosse disponibile, non riassemblare il mezzo.
- Inserire le viti con cautela e serrarle lentamente. Non utilizzare viti con filettatura non appropriata e non serrarle eccessivamente, ma applicare solamente la coppia di serraggio indicata.
- La mancata adesione a queste avvertenze può provocare incidenti anche gravi o letali e danni.

DOMANDE?

Per richiedere eventuali componenti mancanti o per restituire il prodotto, rivolgersi al servizio clienti Segway telefonando al numero 1.866.4SEGWAY (1.866.473.4929) oppure visitare www.segway.com/support/contact_us.html. Visitare www.segway.com per scaricare eventuali aggiornamenti di questo documento. Grazie!

GARANZIA LIMITATA

I modelli Segway PT i2 e x2 Patroller sono soggetti alla garanzia limitata del Segway® Personal Transporter (la scheda di garanzia è acclusa al kit).

ATTREZZI NECESSARI:

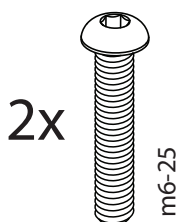
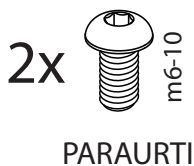
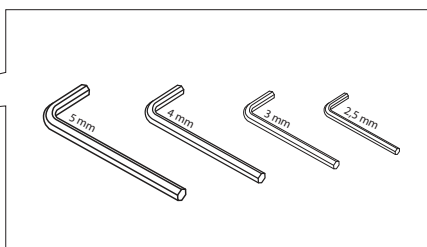
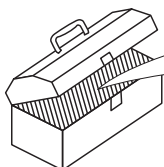

1-1

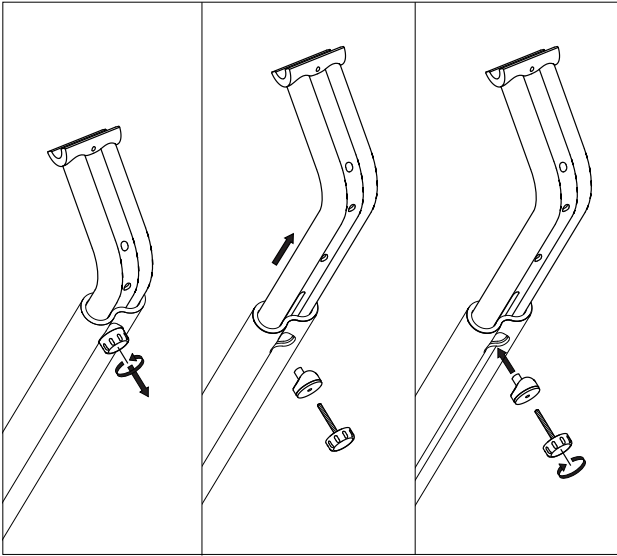

2-1

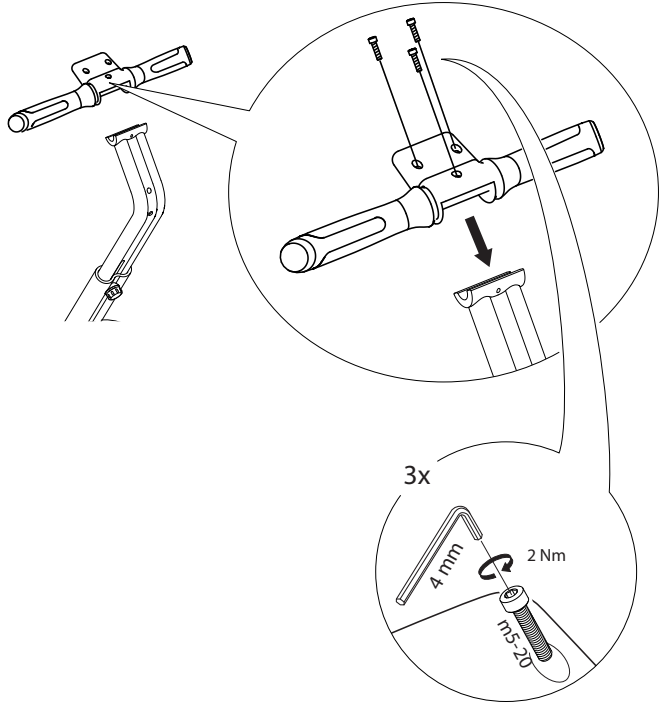

3-1

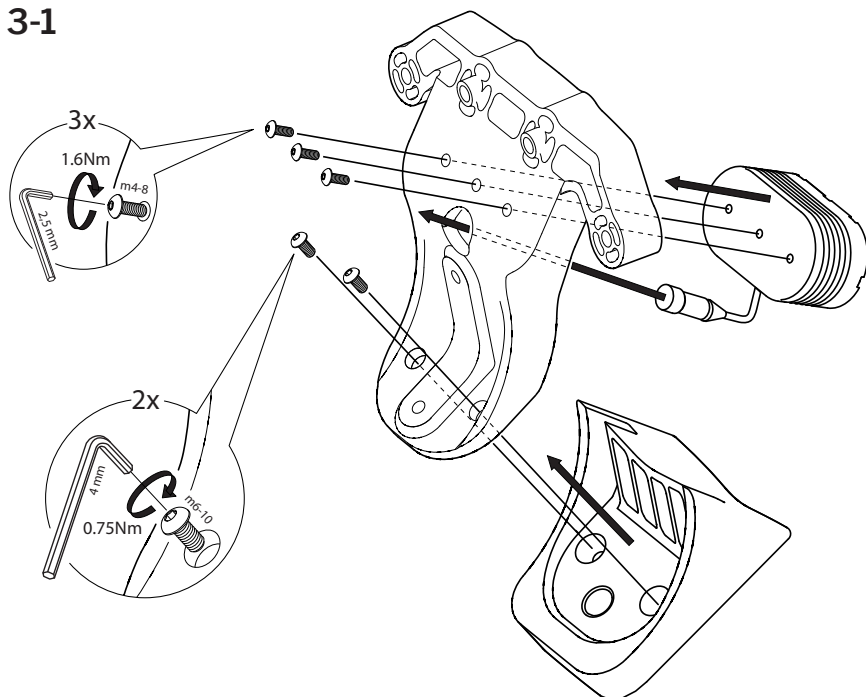

4-1

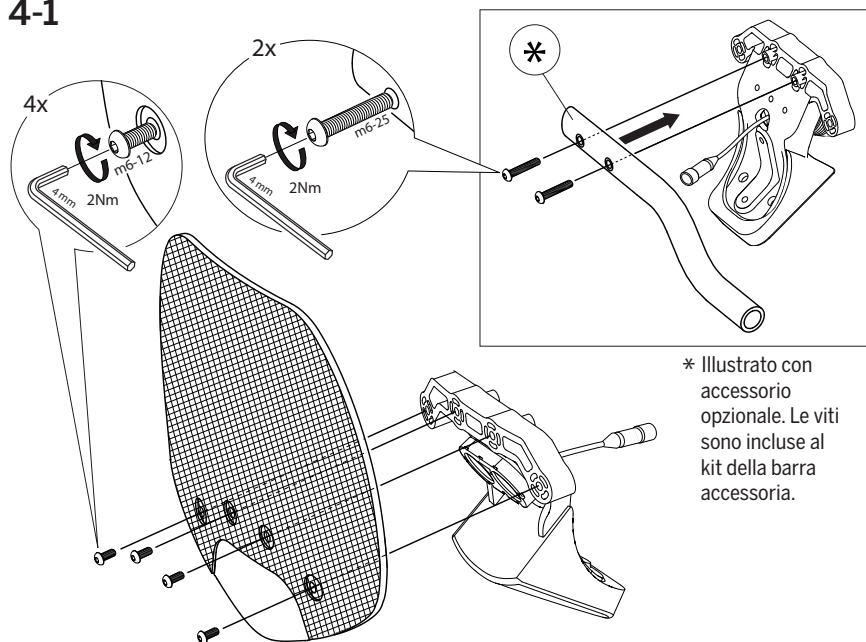

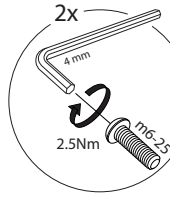
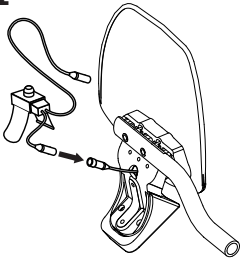
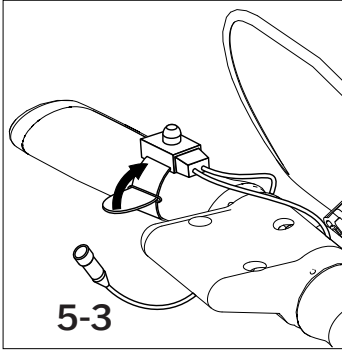
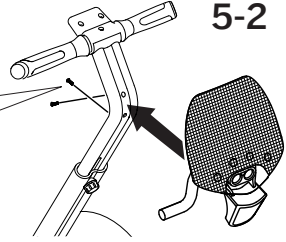
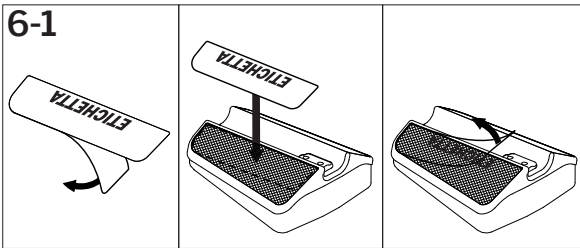
5-1**5-2****5-3****6-1**

Allineare gli angoli dell'etichetta nel modo indicato sul foglietto delle istruzioni per l'applicazione dell'etichetta.

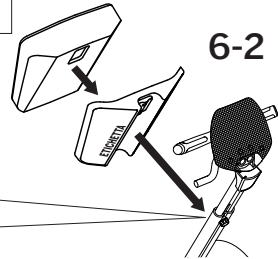
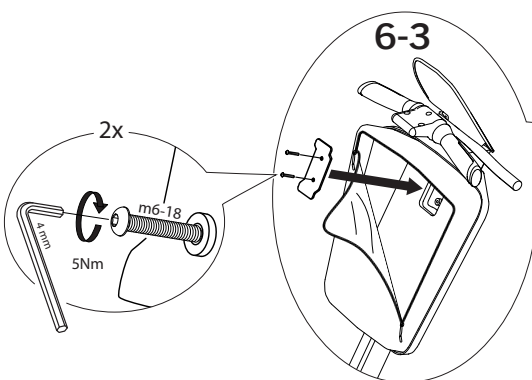
6-2**6-3**

7-1

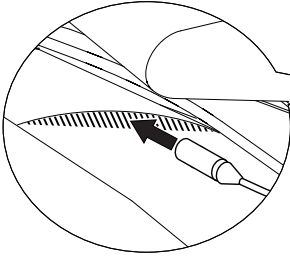

7-2

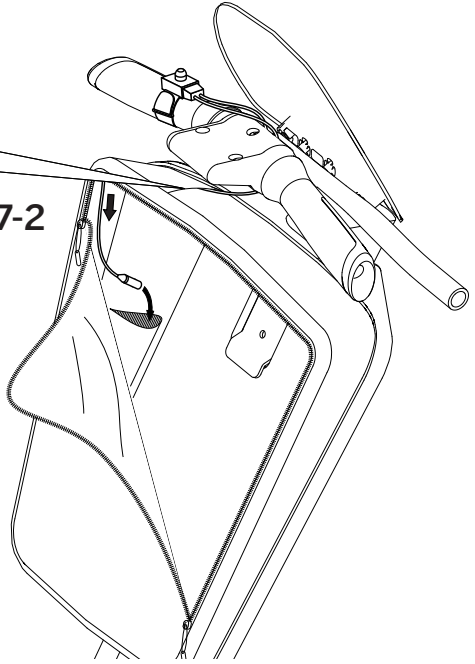

7-3

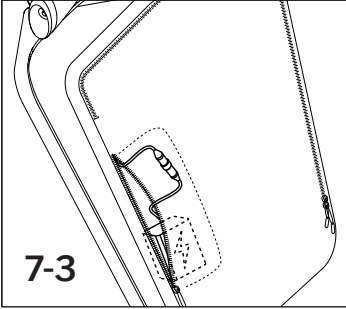

Sicherheit

WARNUNG

- Lesen Sie sich alle Anweisungen in den vorliegenden Anwenderinformationen durch. Nichteinhaltung dieser Warnhinweise kann zu schweren Verletzungen, Tod oder Beschädigungen an Eigentum führen.
- Schalten Sie Ihren Segway PT stets aus und ziehen Sie das Netzkabel, bevor Sie Wartungsarbeiten durchführen und weitere Teile oder Zubehör montieren.
- Verwenden Sie ausschließlich von Segway zugelassene Bauteile, Befestigungselemente und Zubehörteile.
- Versuchen Sie nicht, ausgerissene oder beschädigte Schraubenlöcher zu reparieren. Ersetzen Sie stattdessen das jeweilige Teil. Wenn kein Ersatzteil erhältlich ist, setzen Sie das alte Teil nicht wieder zusammen.
- Drehen Sie die Schrauben langsam und vorsichtig ein. Vermeiden Sie ein Ausreißen des Gewindes und ein übermäßiges Festziehen der Schrauben. Ziehen Sie die Schraube nur bis zum vorgeschriebenen Drehmoment an.
- Ein Missachten dieser Warnhinweise kann schwere oder tödliche Verletzungen oder Sachschäden zur Folge haben.

FRAGEN?

Wenn Ihnen ein Teil fehlt oder Sie das Produkt zurückschicken müssen, wenden Sie sich unter 1.866.4SEGWAY (1.866.473.4929) oder über unsere Website unter www.segway.com/support/contact_us.html bitte an den Segway-Kundendienst. Die aktuellste Ausgabe dieses Dokuments finden Sie im Internet unter www.segway.com. Herzlichen Dank!

EINGESCHRÄNKTE GARANTIE

Die Segway-Modelle PT i2 und x2 Patroller fallen unter die beschränkte Segway® Personal Transporter-Garantie. (Ein Exemplar dieser Garantie liegt diesem Kit bei.)

ERFORDERLICHE WERKZEUGE:

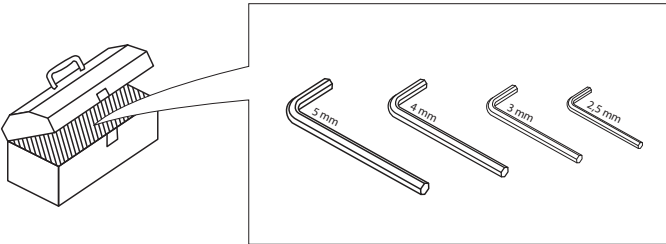

LEUCHE

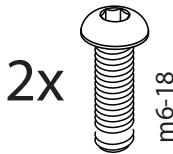

UNTERE BLENDE

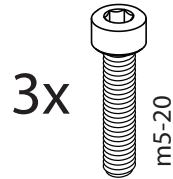

LENKER-
STOSSSTANGENKLEMME



STOSSSTANGE

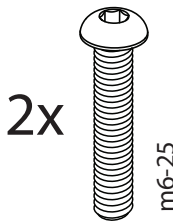

LAMPENHALTERUNG



OBERE BLENDE

1-1

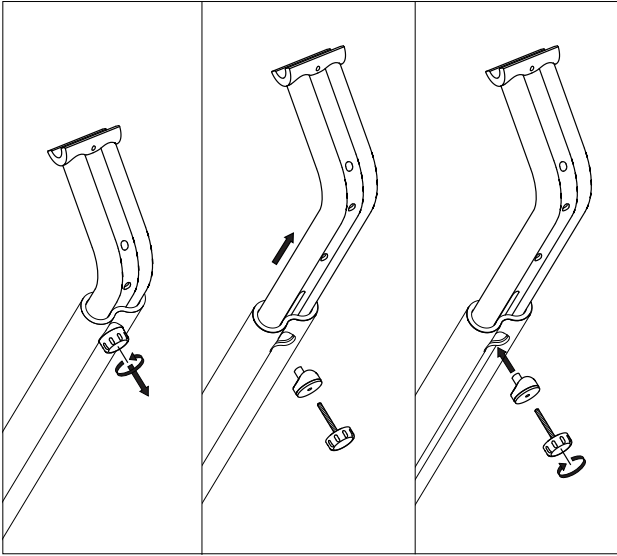

2-1

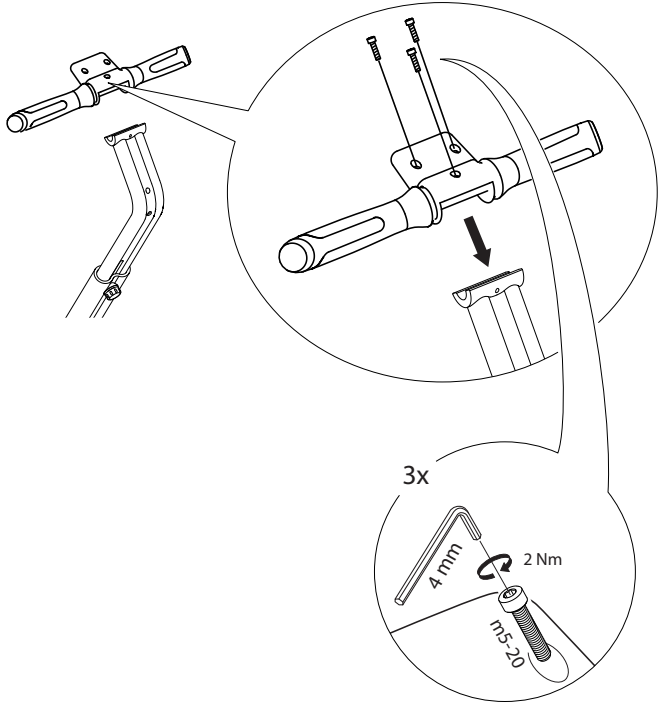

3-1

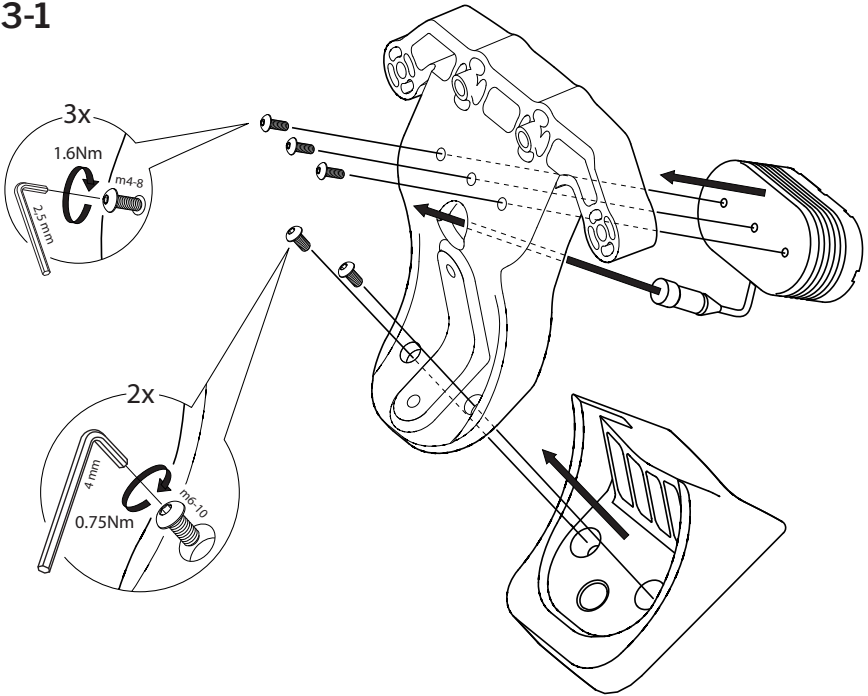

4-1

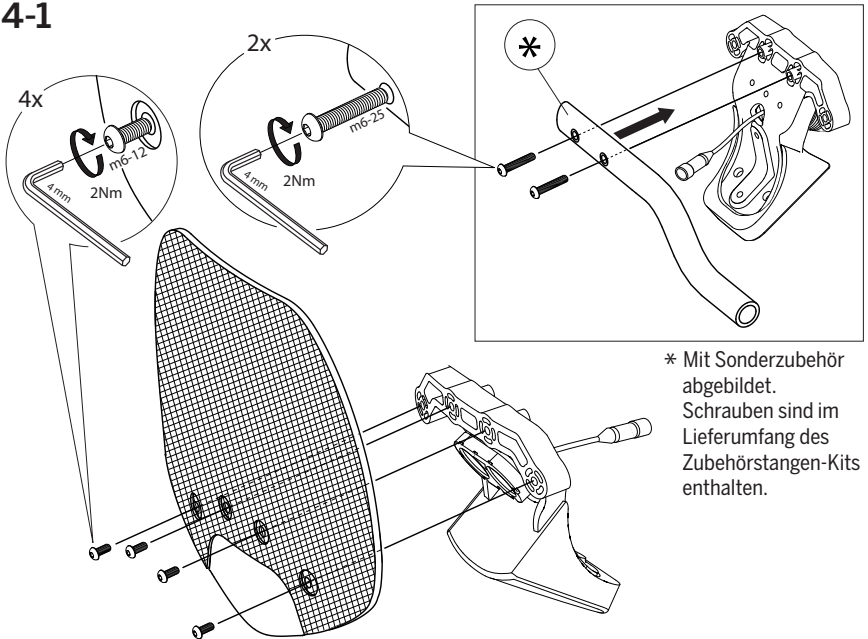

* Mit Sonderzubehör
abgebildet.
Schrauben sind im
Lieferumfang des
Zubehörstangen-Kits
enthalten.

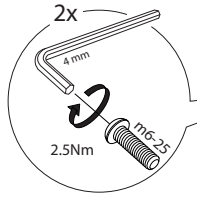
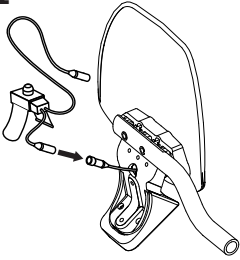
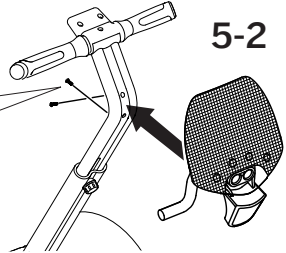
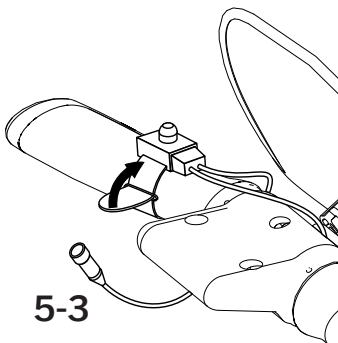
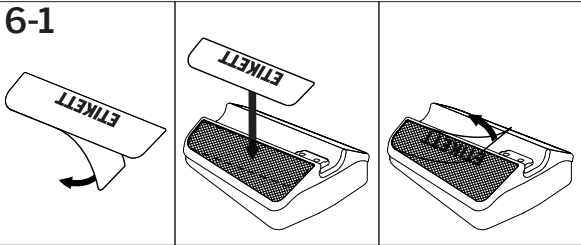
5-1**5-2****5-3****6-1**

Richten Sie die Ecke des Etiketts gemäß der Darstellung auf der Anleitung zur Anbringung des Etiketts aus.

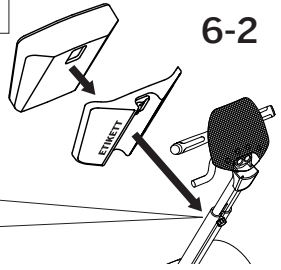
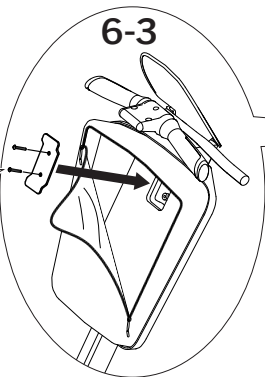
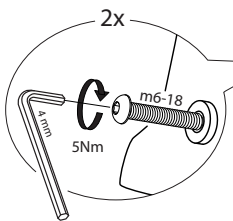
6-2**6-3**

7-1

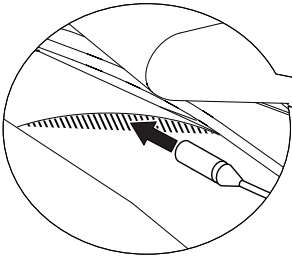

7-2

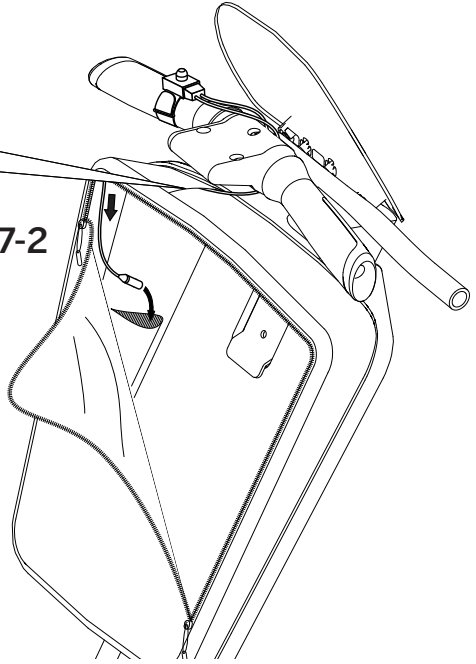

7-3

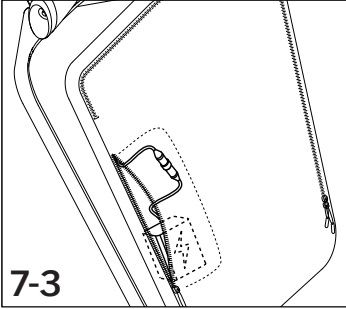

Seguridad

ADVERTENCIA

- Lea todas las instrucciones incluidas en este manual del usuario. Si no sigue estas advertencias, podrían producirse lesiones graves e incluso la muerte, o daños en la propiedad.
- Apague siempre el transportador Segway PT y desconecte el cable de corriente alterna antes de realizar labores de mantenimiento o instalar cualquier pieza o accesorio.
- Utilice únicamente piezas, fijaciones y accesorios aprobados por Segway.
- No intente reparar ningún orificio de tornillo rodado o dañado. En vez de ello, reemplace la pieza. Si no hay un repuesto disponible, no vuelva a armar el equipo.
- Inserte los fijadores en forma lenta y cuidadosa. No estropee las roscas ni los apriete en exceso. Apriete sólo según el par de torsión indicado.
- Si no se acatan estas advertencias podrían producirse lesiones graves o letales, o daños materiales.

¿ALGUNA PREGUNTA?

Si falta alguna pieza o necesita devolver el producto, póngase en contacto con el departamento de Atención al Cliente de Segway llamando el número 1.866.4SEGWAY (1.866.473.4929) o mediante nuestro sitio web en www.segway.com/support/contact_us.html. Consulte www.segway.com para ver si este documento ha sido actualizado. Muchas gracias.

GARANTÍA LIMITADA

Los modelos Segway PT i2 y x2 Patroller están cubiertos por la garantía limitada para transportadores personales Segway® (se incluye un ejemplar de la misma en este kit).

HERRAMIENTAS NECESARIAS:

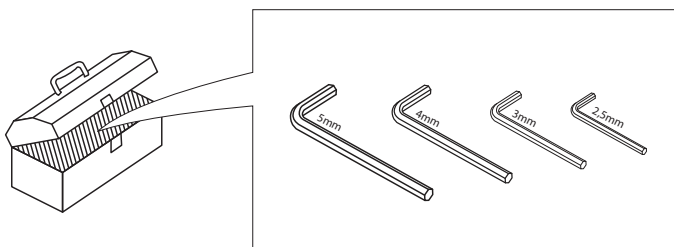

3x
m4-8
LUZ

2x
m6-18
PROTECCIÓN INFERIOR

3x
m5-20
ABRAZADERA
DEL PARACHOQUES
DEL MANILLAR

2x
m6-10
PARACHOQUES

2x
m6-25
SOPORTE DE LA LUZ

4x
m6-12
ROTECCIÓN SUPERIOR

1-1

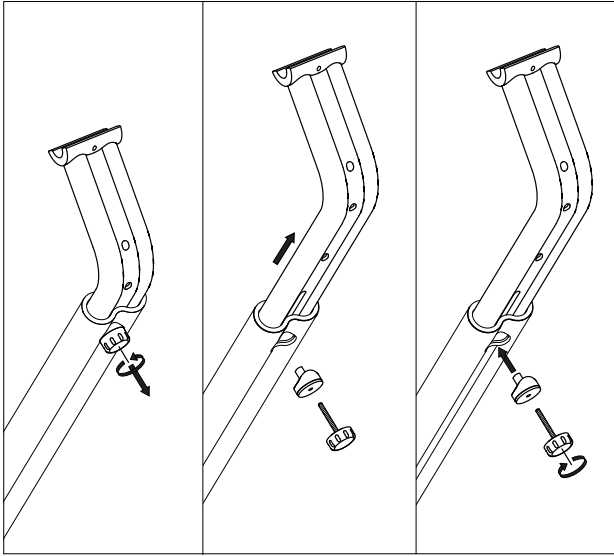

2-1

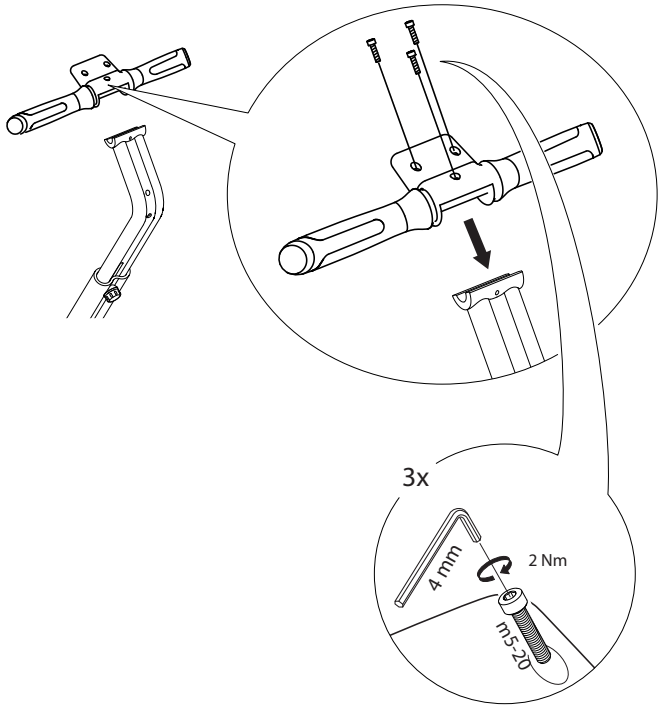

3-1

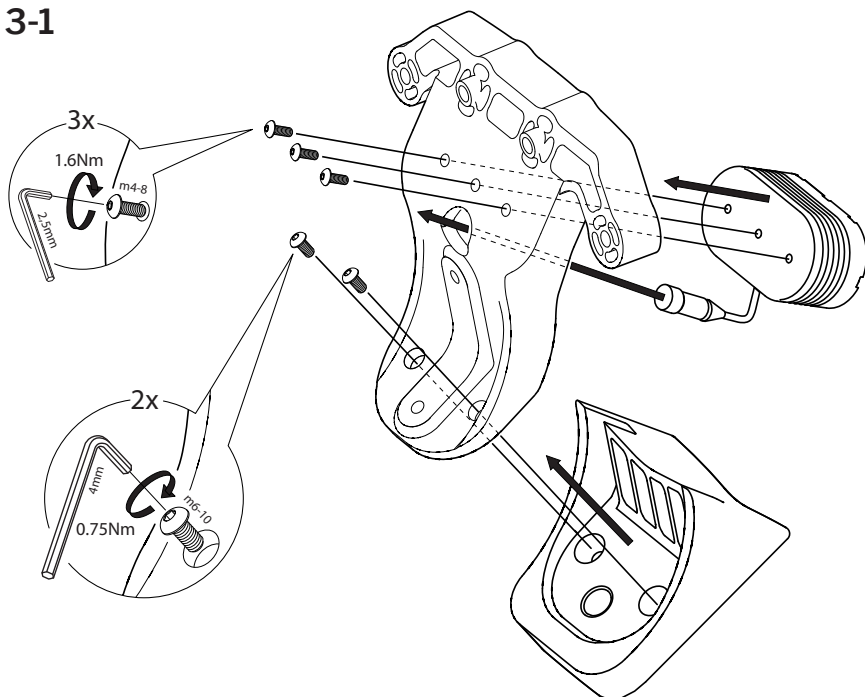

4-1

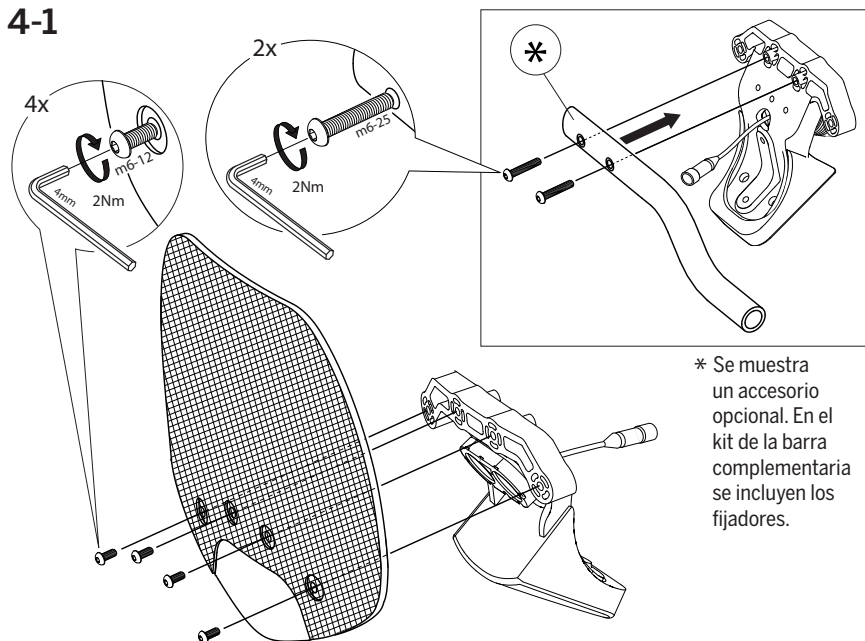

* Se muestra un accesorio opcional. En el kit de la barra complementaria se incluyen los fijadores.

5-1

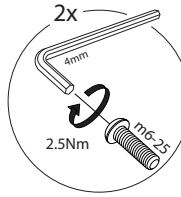
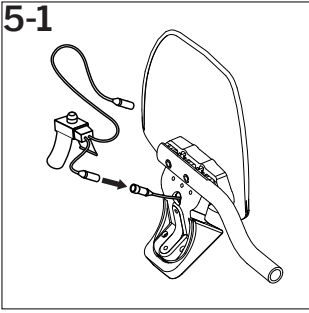

5-2

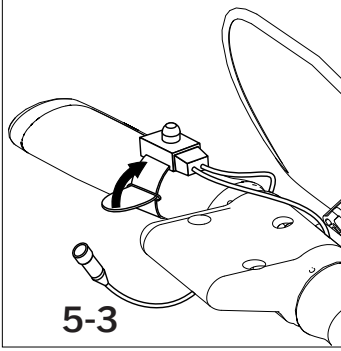
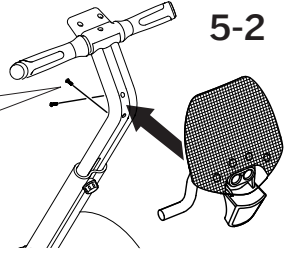

5-3

6-1

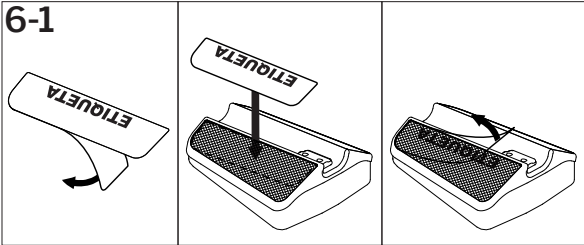

Alinee la esquina de la etiqueta tal como se indica en la hoja de instrucciones para colocar etiquetas.

6-2

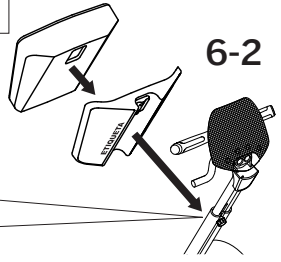

6-3

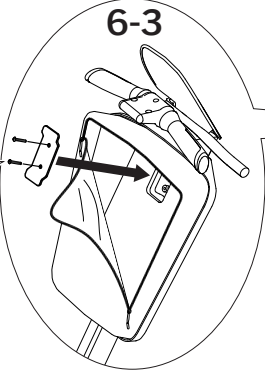
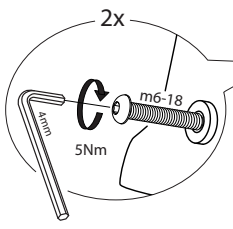

7-1

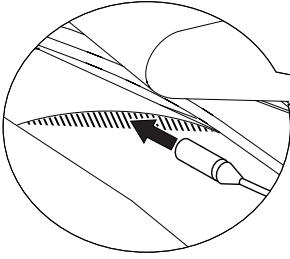

7-2

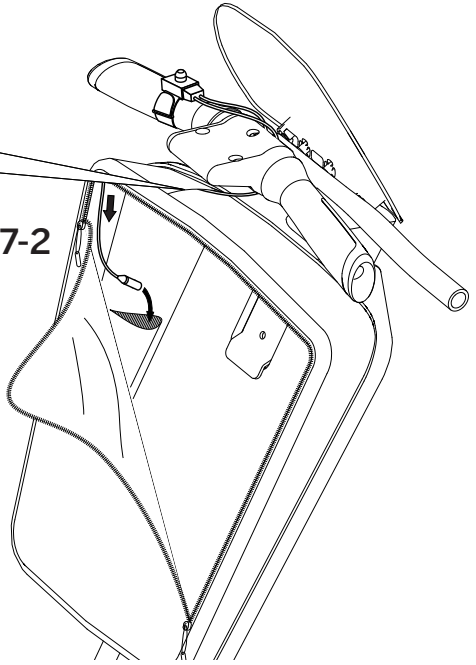

7-3

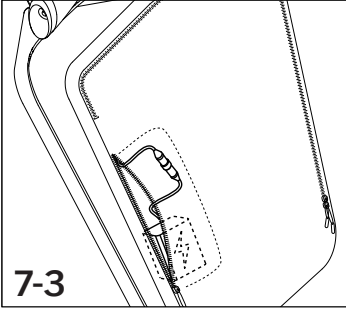

安全上の注意事項

⚠ 警告

- これらの使用説明書の指示をすべてお読みください。これらの警告に従わない場合、重傷または死亡、物損につながる恐れがあります。
- メンテナンスを実施する際、またはパーツや付属品を取り付ける際は、事前にセグウェイ PT の電源を切って AC 電源コードをコンセントから抜いておいてください。
- セグウェイによって承認されたパーツ、留め金具、付属品のみを使用してください。
- ネジ山がつぶれていたり、損傷のあるネジ穴を補修しようとししないでください。補修を試みないで、部品を交換してください。交換部品がない場合、再組立しないでください。
- ファスナーをゆっくりと注意して挿入してください。ファスナーを斜めに締めたり、締め付けすぎないように注意してください。指定のトルクにだけ締めてください。
- これらの指示に従わないと、重大な怪我、死亡、物損につながる危険があります。

お問合せ

部品が不足していたり、本品を返品する必要がある場合は、電話番号 1.866.4SEGWAY (1.866.473.4929)、または、セグウェイ社のウェブサイト www.segway.com/support/contact_us.html から、Segway Customer Operations にご連絡ください。

本書の最新版については、www.segway.com をご覧ください。

有限保証

セグウェイ PT i2 および x2 Patroller モデルは、Segway® Personal Transporter Limited Warranty (キットに同封) によって保証されています。

必要なツール：

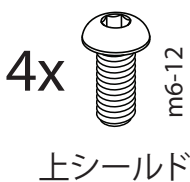
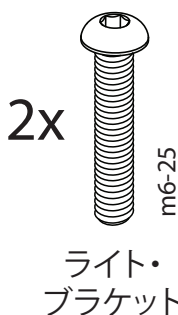
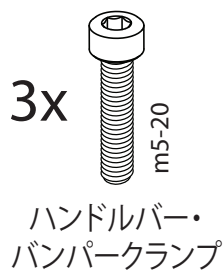
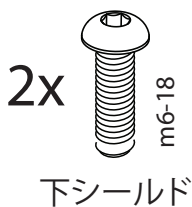
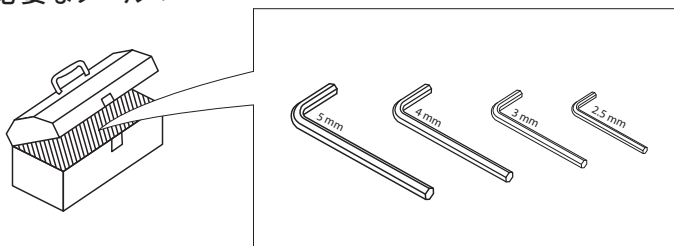

1-1

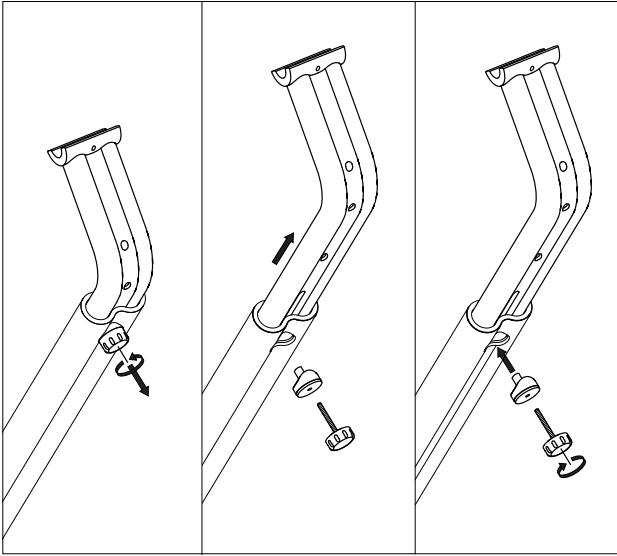

2-1

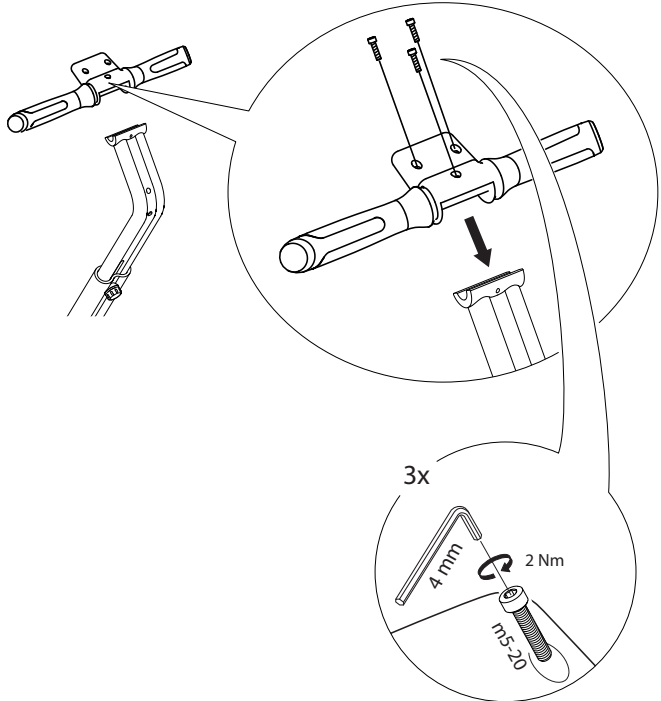

3-1

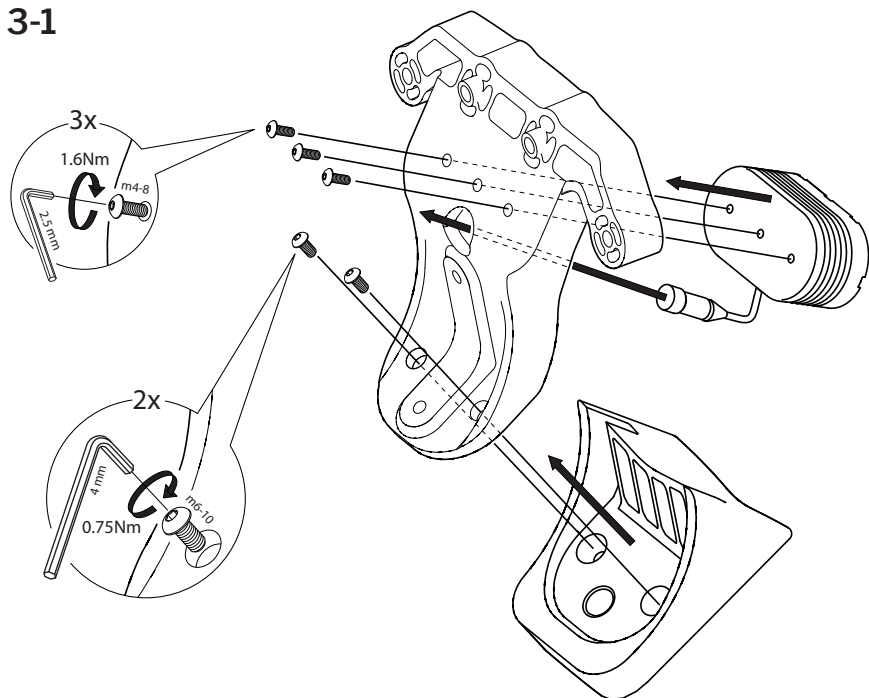

4-1

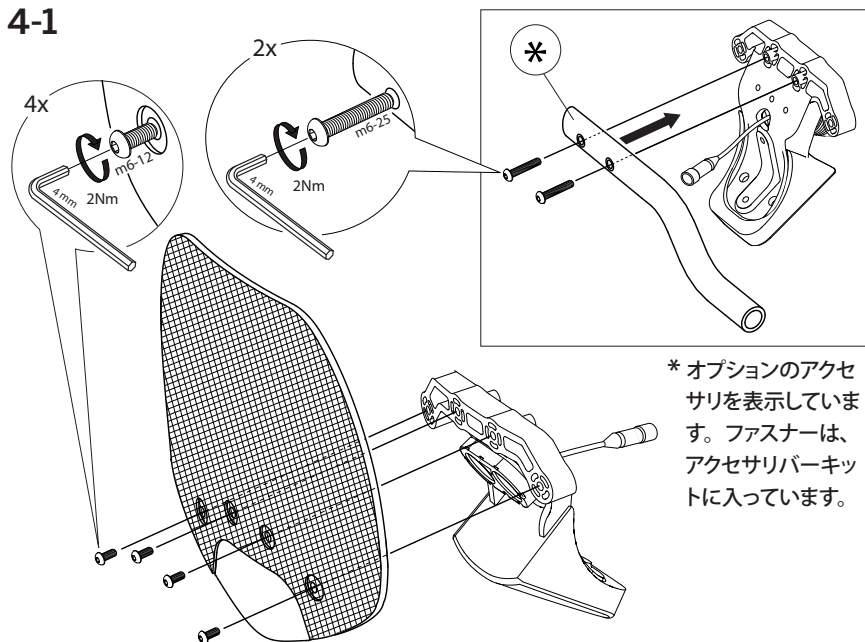

* オプションのアクセサリを表示しています。ファスナーは、アクセサリパーキットに入っています。

5-1

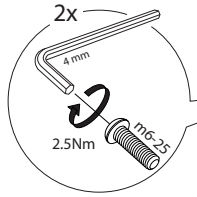
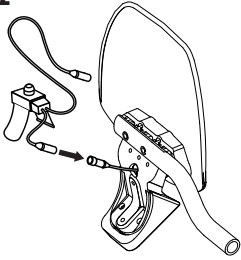

5-2

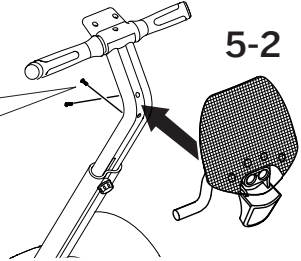

5-3

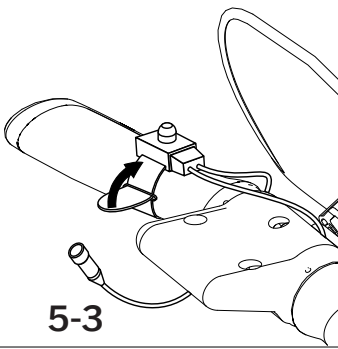

6-1

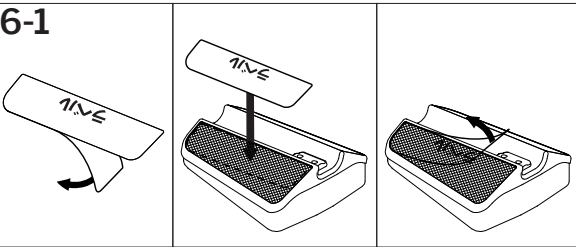

ラベル貼付説明書に示すように、ラベルの端を合わせます。

6-2

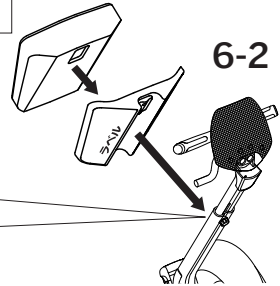

6-3

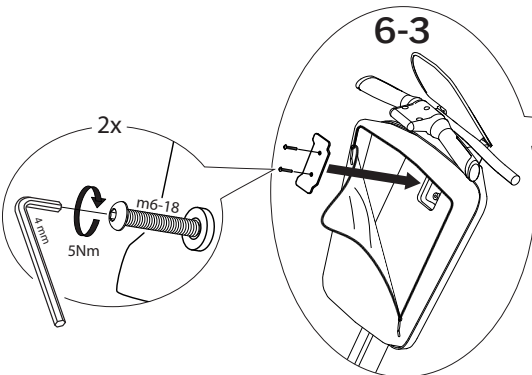

7-1

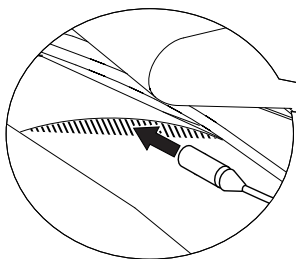

7-2

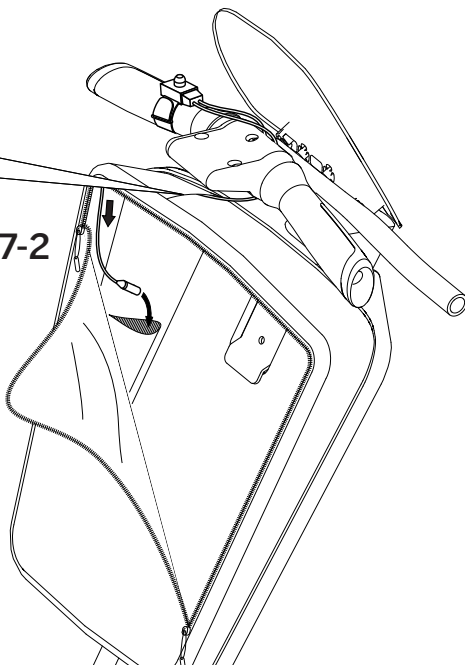

7-3

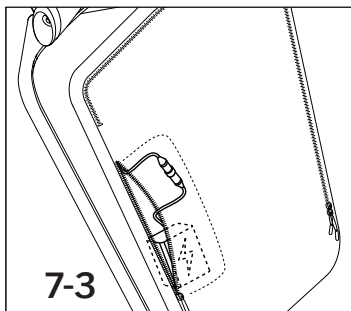

安全

警告

- 请仔细阅读用户资料中的所有说明。忽视这些警告可能导致重伤、死亡或财物损失。
- 在维修或安装任何部件或配件时，务必要关闭 Segway PT 并拔下直流电源线。
- 请仅使用 Segway 认可的部件、紧固件和配件。
- 不要尝试修理任何缺螺纹或受损的螺钉孔，而是替换该零件。如果没有替换零件可用，请先不要重新组装。
- 缓慢谨慎地插入紧固件。不要使紧固件滑丝或旋拧过紧。只按照规定的扭矩进行紧固。
- 不遵守这些警告将可能导致严重伤害、死亡或财产损失。

有问题吗？

如果缺少零件或者需要退还产品，请与 Segway 客户服务部门联系 — 电话 1.866.4SEGWAY (1.866.473.4929)，也可以登录我们的网站 www.segway.com/support/contact_us.html。

请查看 www.segway.com 上是否有本文档的更新。非常感谢！

有限保修

Segway PT i2 和 x2 Patroller 是“Segway® 个人运输车有限保修单”（随套件提供副本）担保的型号。

所需工具：

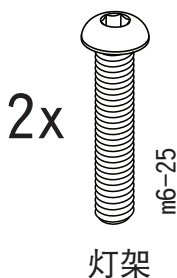
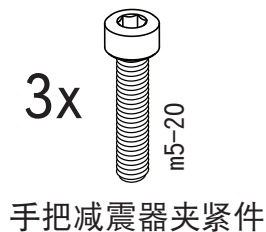
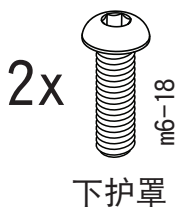
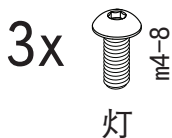
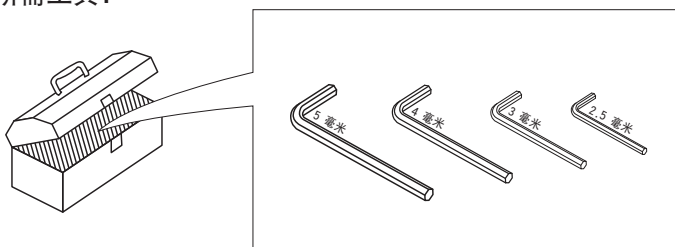

1-1

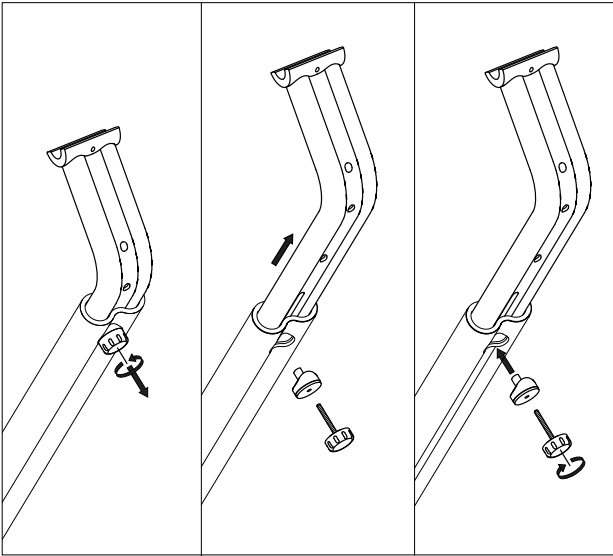

2-1

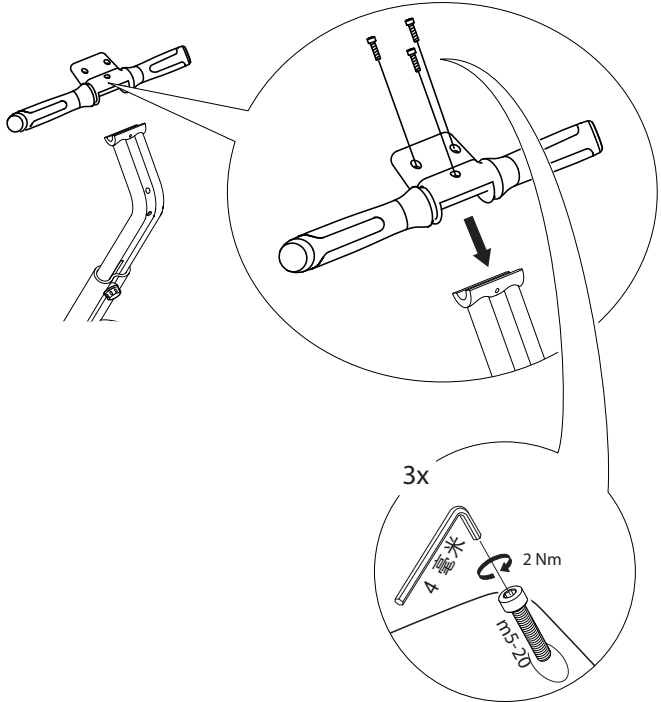

3-1

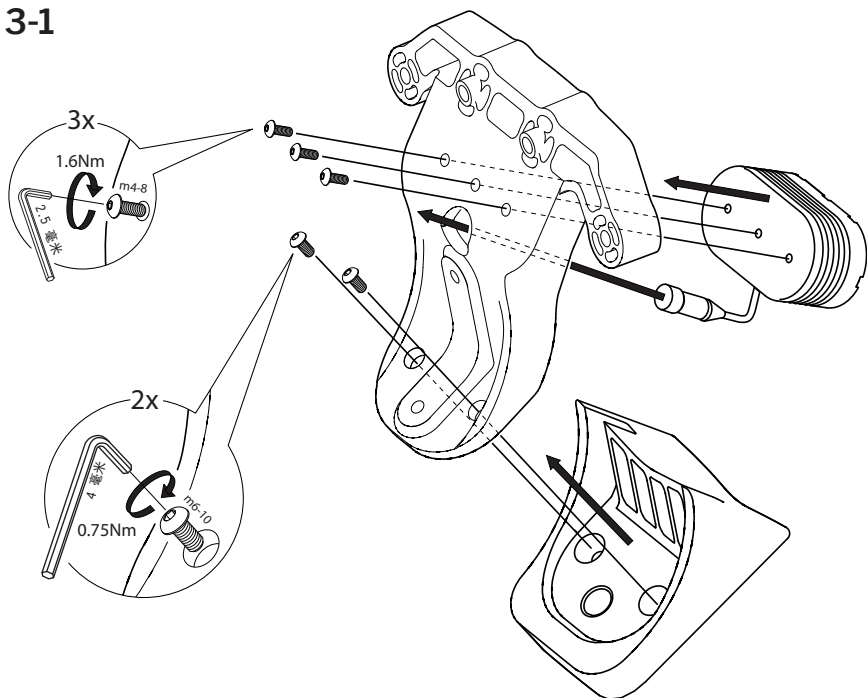

4-1

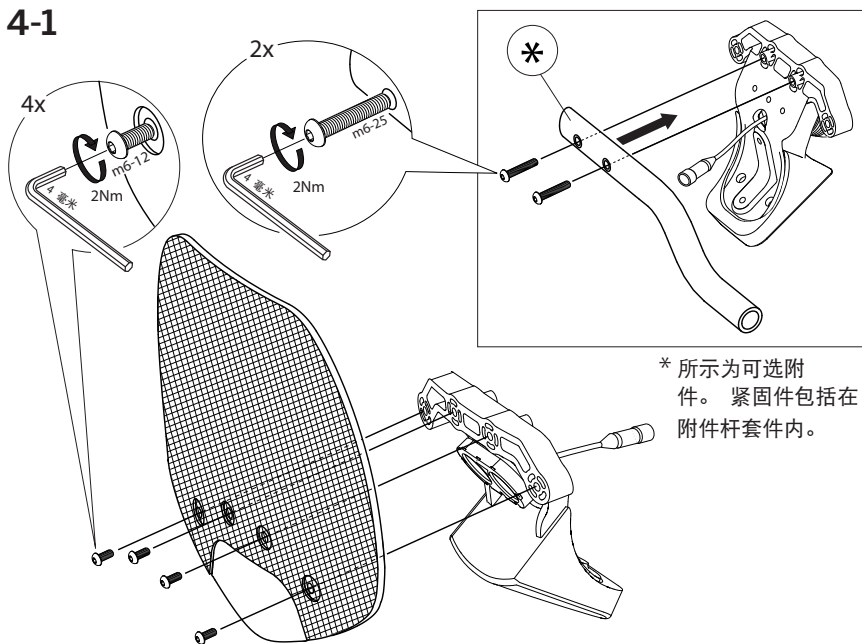

5-1

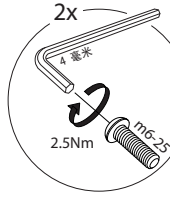
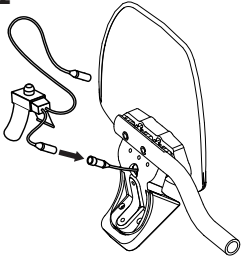

5-2

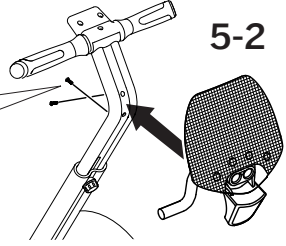

5-3

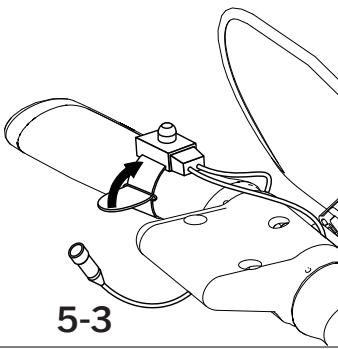

6-1

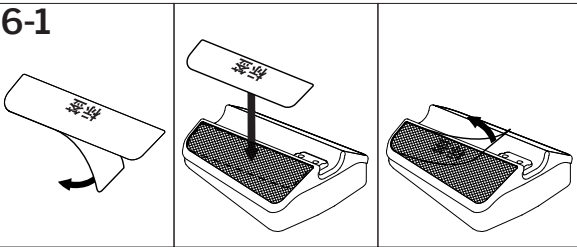

根据标签应用说明页的指示对齐标签角。

6-2

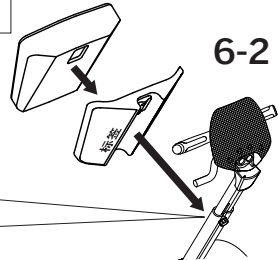

6-3

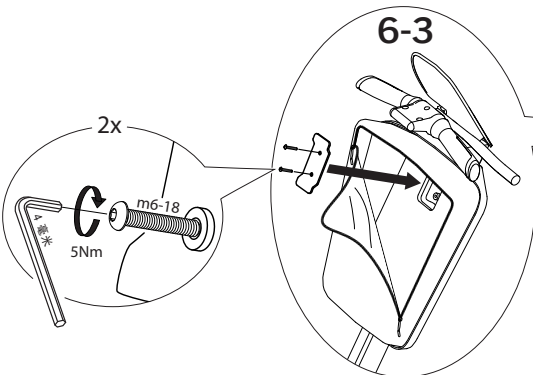

7-1

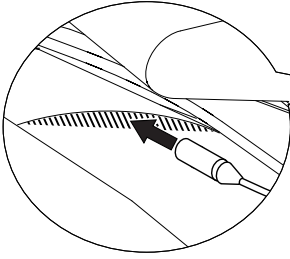

7-2

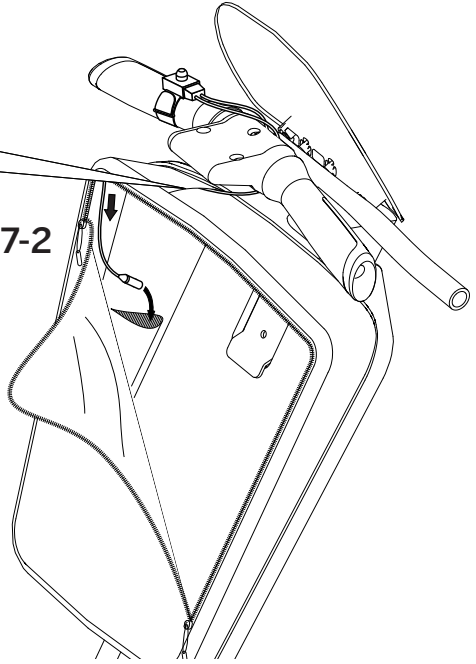

7-3

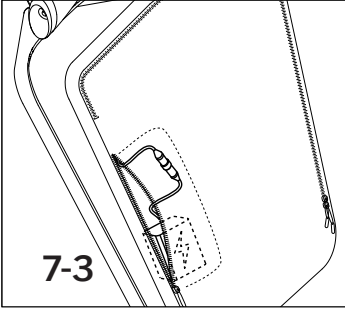

NOTES

NOTES



23992-00001 ac

Segway® and the Segway 'Rider design' are registered trademarks of Segway Inc. ("Segway"). Other marks including InfoKey and LeanSteer, are trademarks or common law marks of Segway. Segway reserves all rights in its trademarks. Copyright© 2015 Segway Inc. All rights reserved.